

Rushton & Mackie Streets - Concept

Legend

Traffic Calming

- "Safe Active Streets" principles
- Paved Intersection
- 1 Narrowing of road width (7.0m)
- 2 Tightening of intersection kerb radius *
- 3 Catenary lighting to unite intersection
- Shared space - Raised intersection - Flush kerbs

Creation of public Space

- Parking removed except to Rushton Street
- 4 Parking
- 5 Performance stage and canopy
- 6 Corner artwork opportunities
- 7 Artwork graphics to paved surface

Urban Forest & Verge Planting

- 8 Increase tree planting
- 9 Retain & integrate existing street trees
- 10 Verge / Rain gardens

Support F&B Alfresco

- 11 Alfresco
- 12 Parklets / Outdoor Lounges

Events Infrastructure

- 13 Pop up bollards to close square to vehicles (special events)

Other

- 14 Busking spots
- 15 Bike Parking

*John Hughes car carrier access and manoeuvring requirements - Refer to GTA Technical Notes





Existing Road Layout Overlay



Rushton & Mackie Streets - Concept









Zones

-  Alfresco Zones
-  Pedestrian Clear Zones (min 2.5m)
-  Verge Planting



Rushton & Mackie Streets - Concept

Public Realm Amenity

-  Seating Edges
-  Artwork (Interactive)
-  Catenary Lighting
-  Bike Racks
-  Drop Bollards
-  Raingardens / Verge Planting
-  Alfresco Zones
-  Stage & Canopy

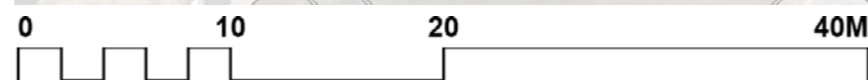

Precedent Projects

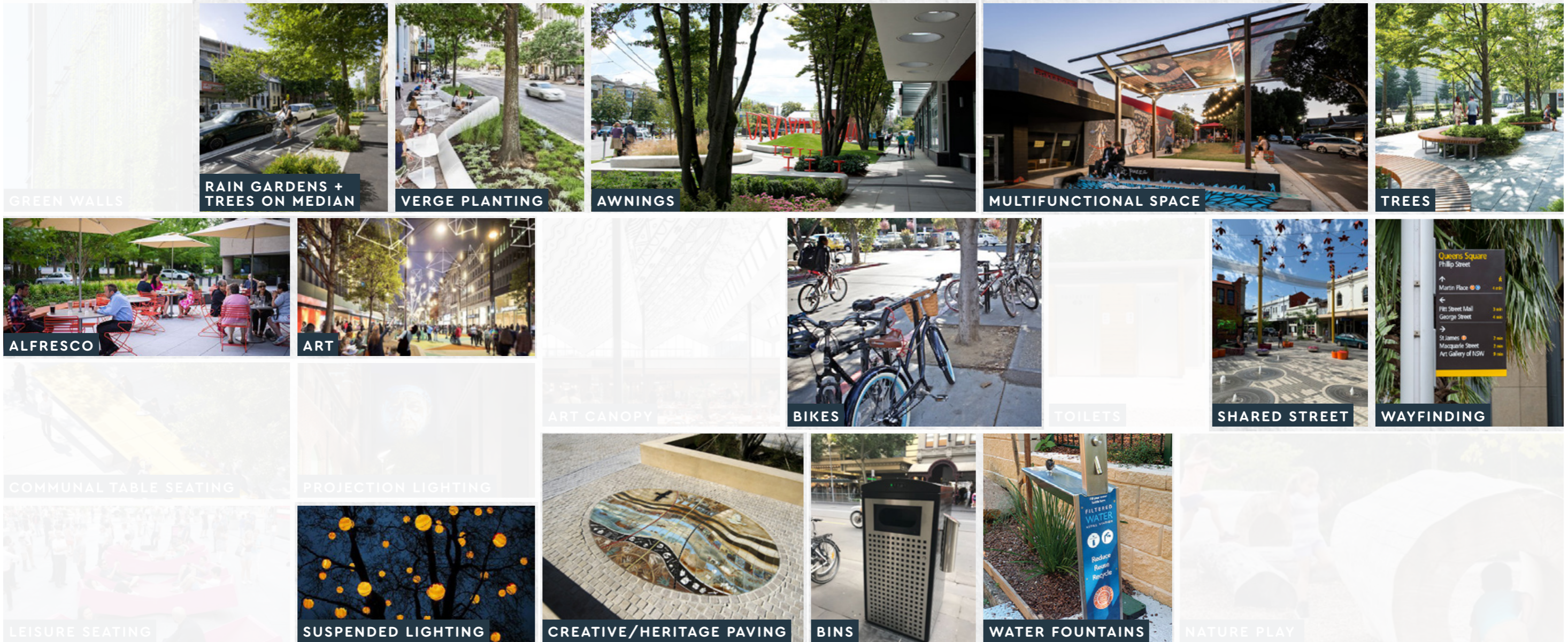

Precedent Projects

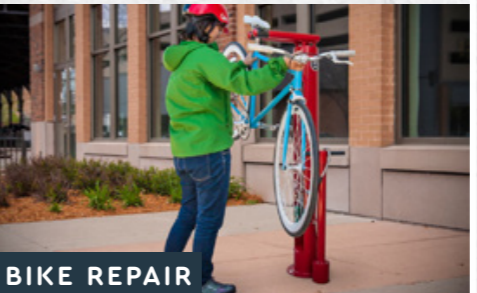

Perspectives



PERSPECTIVE 1 : Albany Highway looking east (away from Perth City)

Perspectives



PERSPECTIVE 2 : Albany Highway looking west (towards Perth City)

Site Sections

- 1 Narrowing of road width (6.0m)
- 2 Catenary lighting to unite intersection
- 3 Shared space - Raised intersection - Flush kerbs
- 4 Corner artwork opportunities
- 5 Tree planting
- 6 Existing Trees retained
- 7 Verge / Rain gardens
- 8 Alfresco
- 9 Parklets / Outdoor Lounges



SECTION A - ALBANY HIGHWAY

EAST

WEST

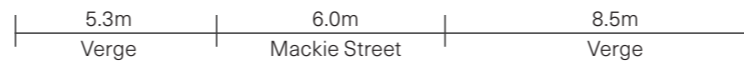

Site Sections

- 1 Narrowing of road width (7.0m)
- 2 Catenary lighting to unite intersection
- 3 Shared space - Raised intersection - Flush kerbs
- 4 Corner artwork opportunities
- 5 Tree planting
- 6 Existing Trees retained
- 7 Verge / Rain gardens
- 8 Alfresco
- 9 Parklets / Outdoor Lounges



SECTION B - MACKIE STREET



Site Sections

- 1 Narrowing of road width (7.0m)
- 2 Catenary lighting to unite intersection
- 3 Shared space - Raised intersection - Flush kerbs
- 4 Corner artwork opportunities
- 5 Tree planting
- 6 Existing Trees retained
- 7 Verge / Rain gardens
- 8 Alfresco
- 9 Performance stage and canopy



SECTION C - RUSHTON STREET



Perspectives

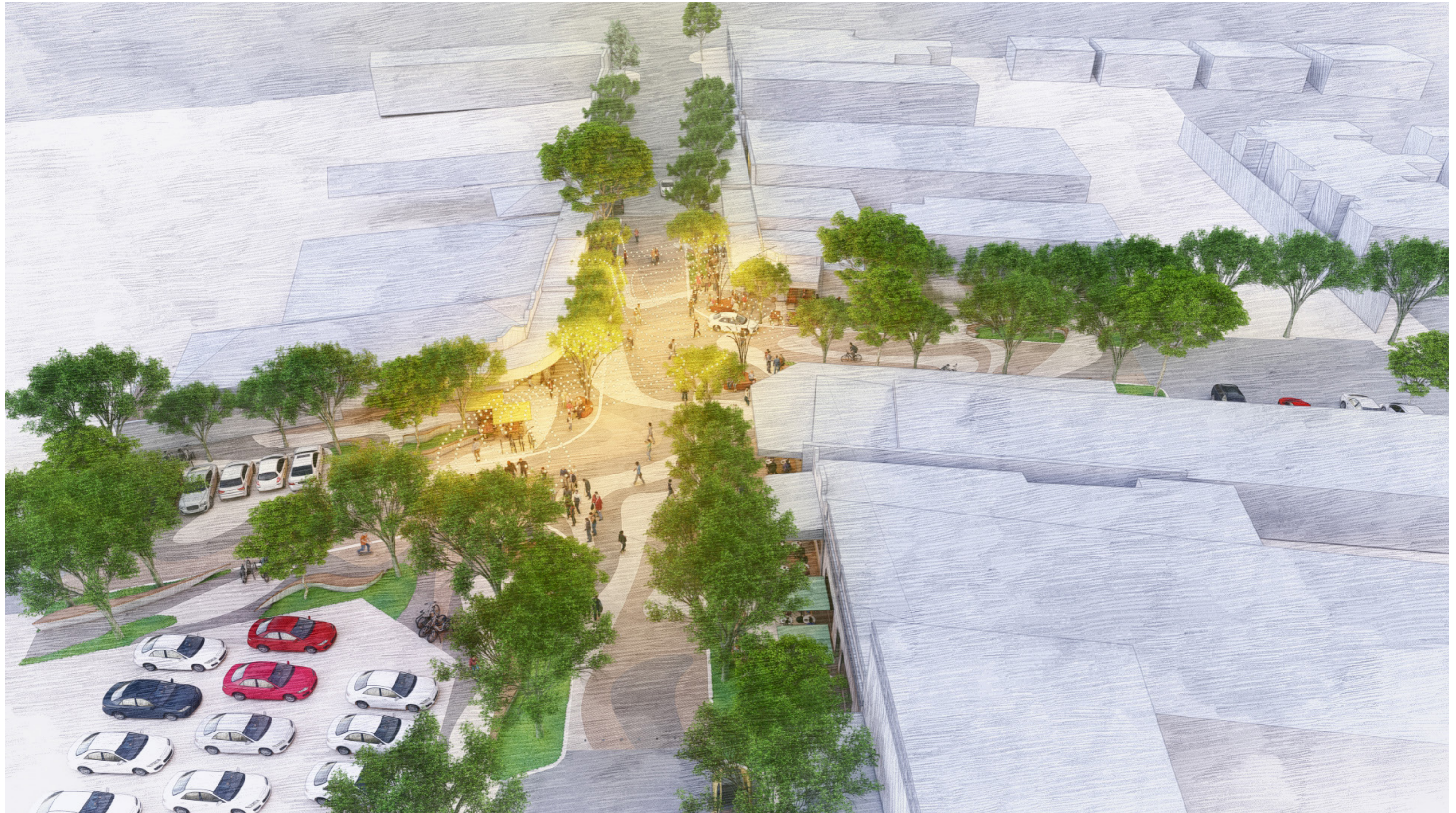

Perspectives

